

# LLD RENOVATION PROJECT

## PROJECT TEAM

SHEEHAN  
NAGLE  
HARTRAY  
ARCHITECTS

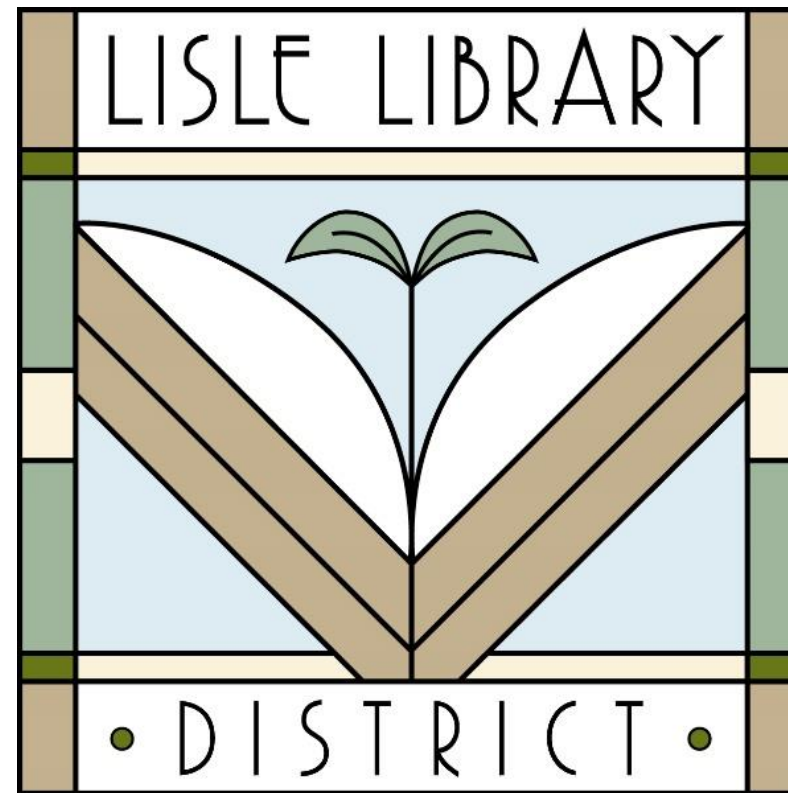

ACCESSIBILITY | FUNCTIONALITY | CONVENIENCE

# LISLE LIBRARY DISTRICT RENOVATION UPDATE

## PROJECT INCLUSIONS:

- Installing family restrooms in Youth Services + additional single-use restrooms in facility
- Rightsizing the Youth Services Department to mirror Adult Services sq. footage
- Creating a Teen space
- Improving accessibility: main entrance on Front St. + south side entrance for upper level
- Adding more study rooms
- Installing drive-up service window
- Creating an outdoor reading/programming space
- Enhancing RFID technology: new sorting system and self-checks
- Optimizing sightlines/security
- Improving IT infrastructure + increasing electrical access throughout facility

## BUDGET: 7.7M

AFTER MANY YEARS OF THOUGHTFUL PLANNING AND RESPONSIBLE SAVING, THE RENOVATION SHALL BE PRIMARILY FUNDED USING THE LLD'S OPERATIONAL AND SPECIAL RESERVES:

Corporate/Operational Fund: 2.8M

Special Reserve Fund: 3.9M

Debt Certificate: 1M

Total Budget: 7.7M

## WANT MORE INFO?

VISIT [LISLELIBRARY.ORG](http://LISLELIBRARY.ORG), GO TO 'ABOUT US' & CLICK **LLD CAPITAL PROJECTS** TO VIEW DOCUMENTS, PRESENTATIONS, & VIDEOS RELATED TO THE RENOVATION.

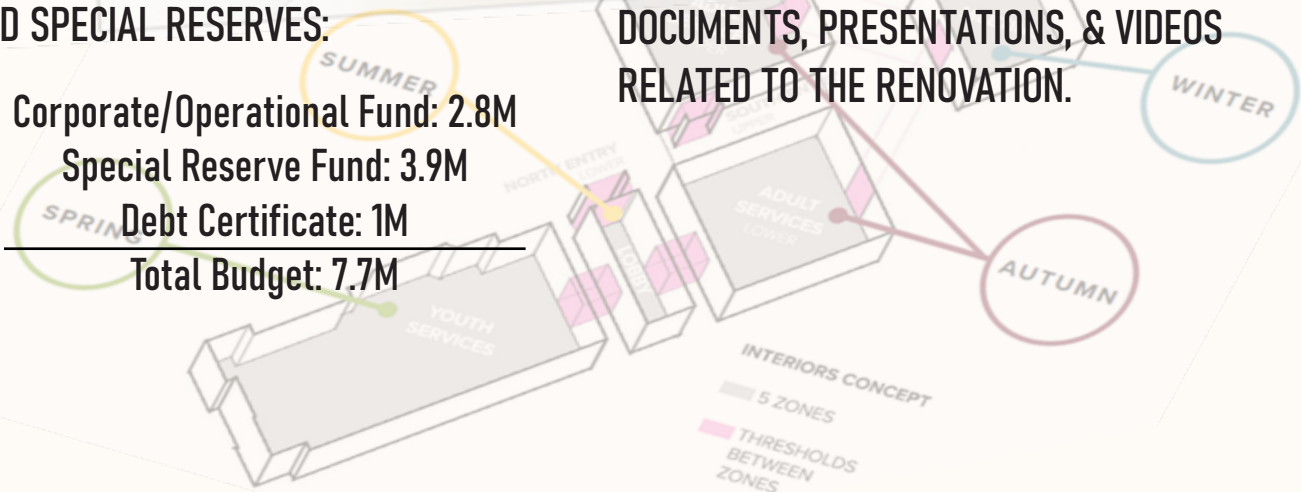

# LOWER FLOOR PLAN

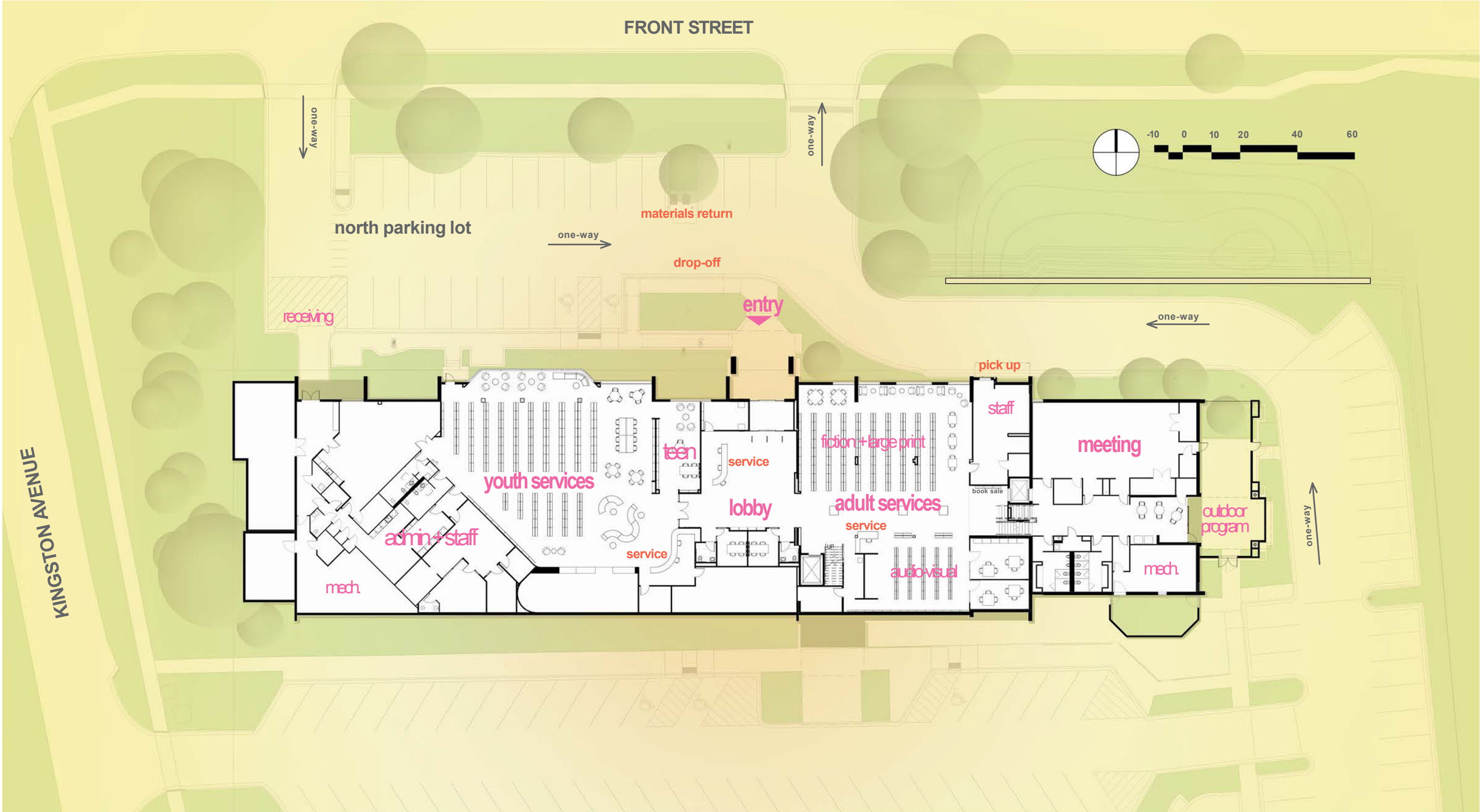

# UPPER FLOOR PLAN

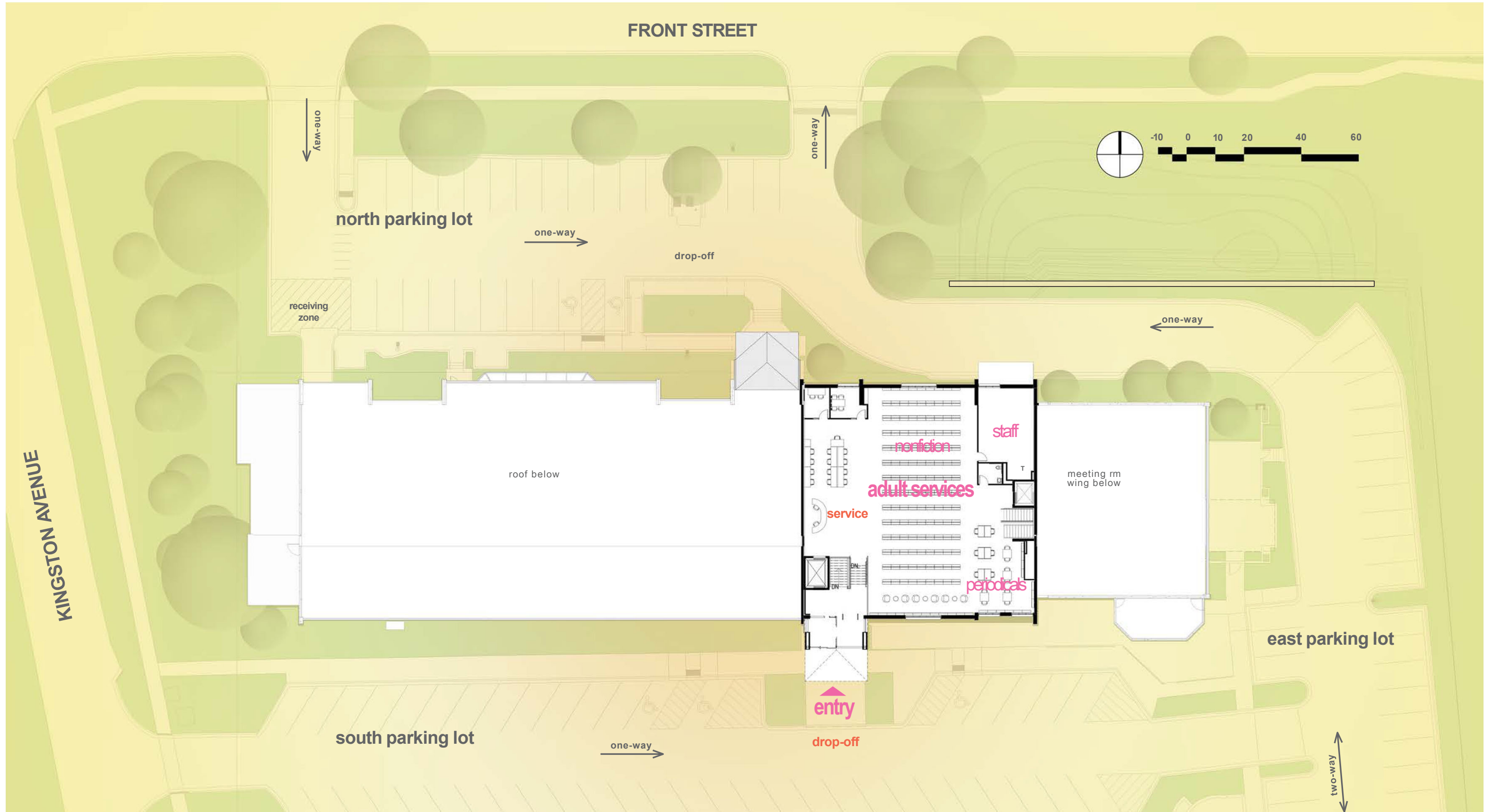

# NORTHWEST AERIAL



# NORTH ENTRY

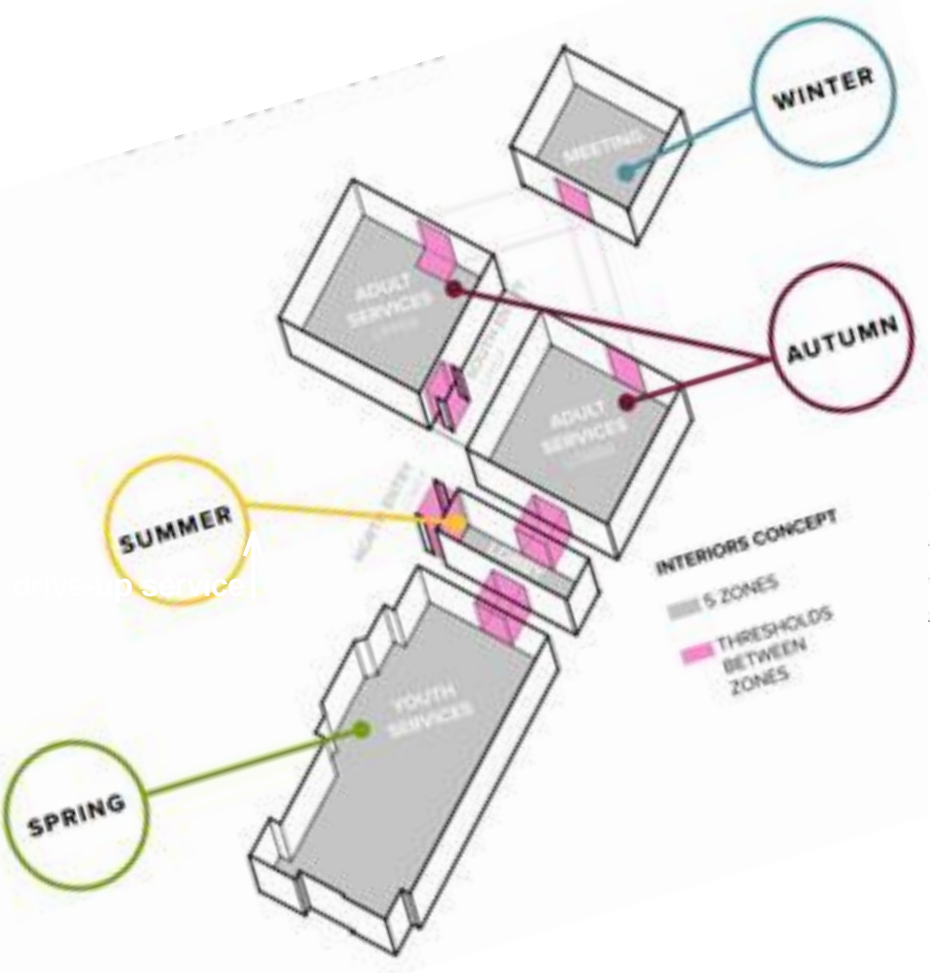



**LLD RENOVATION  
GROUNDBREAKING  
MARCH 21, 2022**